

# Scenic 'Space-Ship' Deckplan

Scenic Sapphire, Scenic Emerald, Scenic Diamond, Scenic Ruby and Scenic Pearl

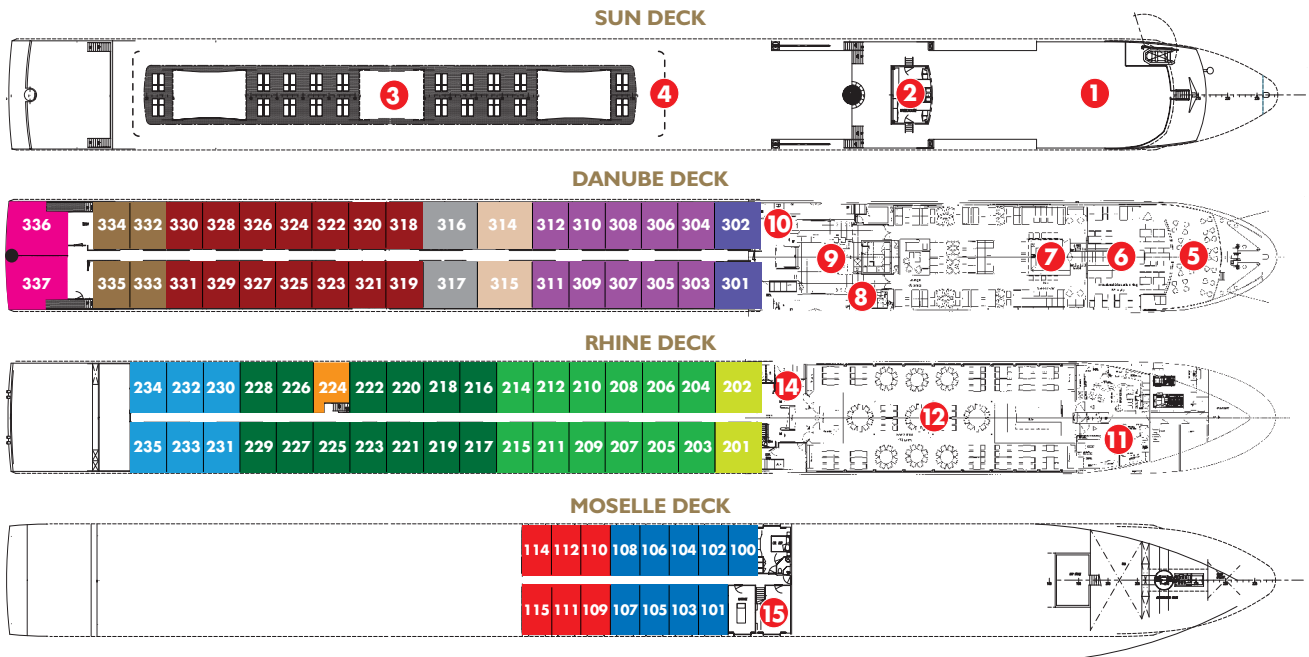
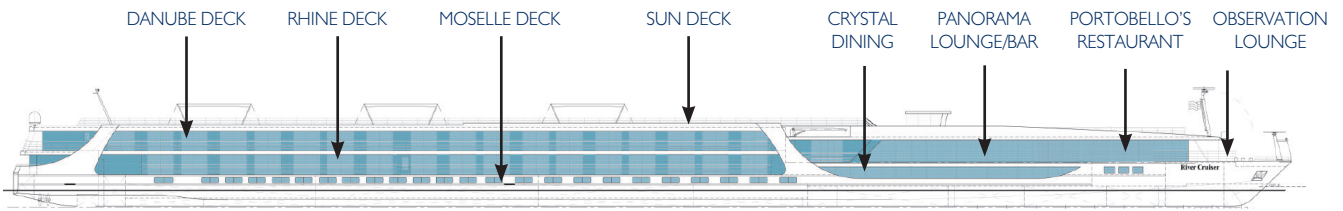

## TECHNICAL DATA

Built: 2008/2009/2011  
 Length: 135 metres  
 Passengers: 169  
 Cabins: 85  
 Crew: 48  
 Gross Tonnage: 2,721 Tons

## DECK PLAN

- 1 Observation Deck
- 2 Wheel house
- 3 Sun Deck
- 4 Walking Track
- 5 Observation Lounge
- 6 Portobello's Restaurant
- 7 Panorama Lounge & Bar
- 8 Gift Shop
- 9 Reception
- 10 Elevator
- 11 Kitchen
- 12 Crystal Dining Restaurant
- 14 Elevator
- 15 Wellness Area

## CABIN CATEGORIES

### DANUBE DECK

- R Royal Balcony Suite
- RA Royal Balcony Suite
- RJ Junior Balcony Suite
- S Junior Balcony Suite
- P Balcony Suite
- PA Balcony Suite
- A Balcony Suite

### RHINE DECK

- BJ Junior Balcony Suite
- BS Single Balcony Suite
- B Balcony Suite
- BA Balcony Suite
- C Balcony Suite

### MOSELLE DECK

- D Standard stateroom
- E Standard stateroom

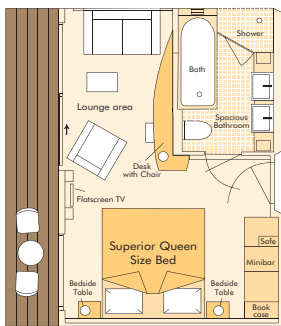

Royal Suite 29m<sup>2</sup>/315ft<sup>2</sup>  
(R Category)

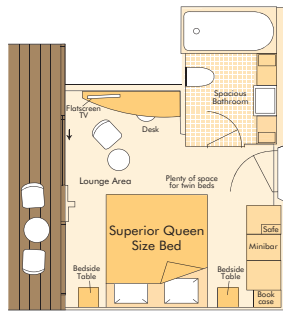

Junior Suite 23m<sup>2</sup>/250ft<sup>2</sup>  
(RJ, BJ Category)

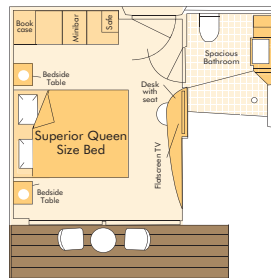

Private Balcony Suite 19m<sup>2</sup>/205ft<sup>2</sup>  
(P, PA, A, B, BA, C Category)

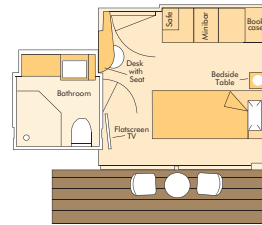

Private Balcony Suite  
Single Cabin 11.7m<sup>2</sup>/129ft<sup>2</sup>  
(BS Category)

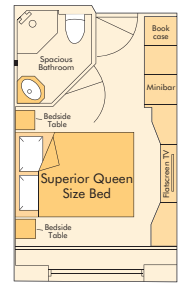

Stateroom 15m<sup>2</sup>/160ft<sup>2</sup>  
(D and E Category)

RA Royal Suite differs from above and is 300 ft<sup>2</sup>. Cabin plan for Junior Suite (302) and Category S differs from the above diagram. Junior Suite 302 features disabled amenities and does not include a bath. Scenic Pearl – Cabins 303 and 304 are RJ Junior Balcony Suites. The deckplan and cabin layout images are an indication only and may vary.